

K7195 RETRACTABLE LAP SASH SEATBELT

K7195 SPECIFICATIONS

- The Klippan Retractable Lap Sash seatbelt fully extended measures approximately 3.2mtrs. Shorter 'S' versions measuring 2.6mtrs and longer 'L' versions measuring 3.8 mtrs are also available.

K7195	Standard	3.2 mtrs
K7195S	Short	2.6 mtrs
K7195L	Long	3.8 mtrs

- The retractor should be mounted externally. Fig 1
- The retractor is designed to mount 10 degrees off vertical. Fig 2
- Buckle is 110mm from centre of bolt hole to press button and is designed to mount to the side of the seat. Fig 3

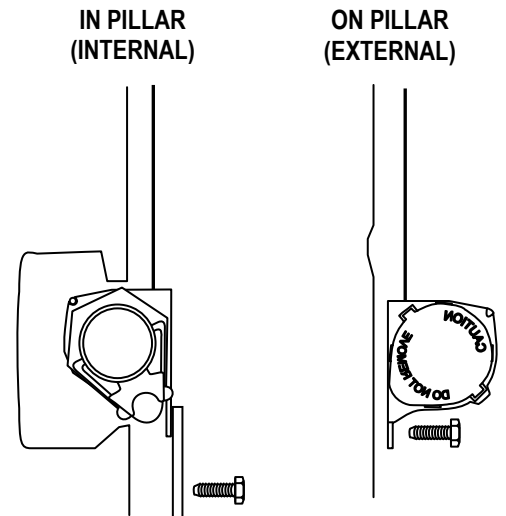

SHOWN FOR
REFERENCE ONLY

FIGURE 1

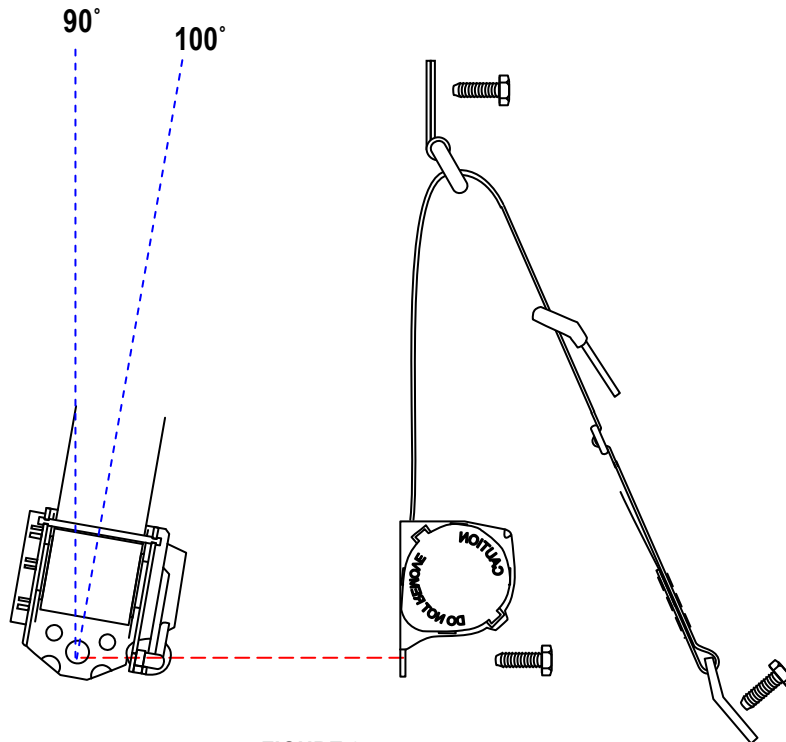

FIGURE 2

SEAT MOUNT STEM
BUCKLE (110mm)

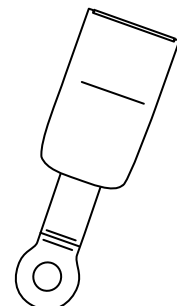

FIGURE 3