

W SERVICE PROCEDURE **AIRBAG**

1. Supplemental Restraint System "Airbag"

Airbag warning system is located in the combination meter.

- a. All Airbag system wiring harness and connectors are colored yellow. Do not use electrical equipment on these circuit.
- b. Be careful not to damage Airbag warning system wiring harness when servicing the combination meter.

2. Console Box

A: REMOVAL

- 1) Disconnect ground cable from battery.
- 2) Remove console panel by taking off three clips from both sides.

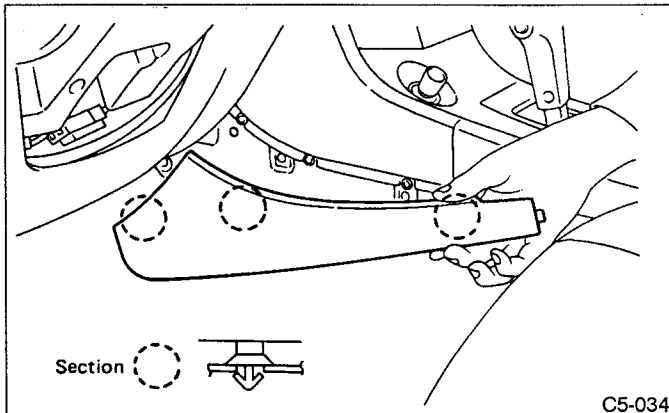

Fig. 4

- 3) Remove two screws from both the left and right sides.

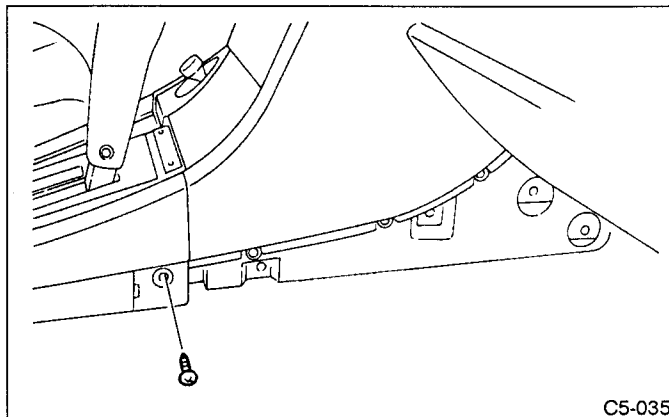

Fig. 5

- 4) Remove automatic transmission cover, tray and console box mat.

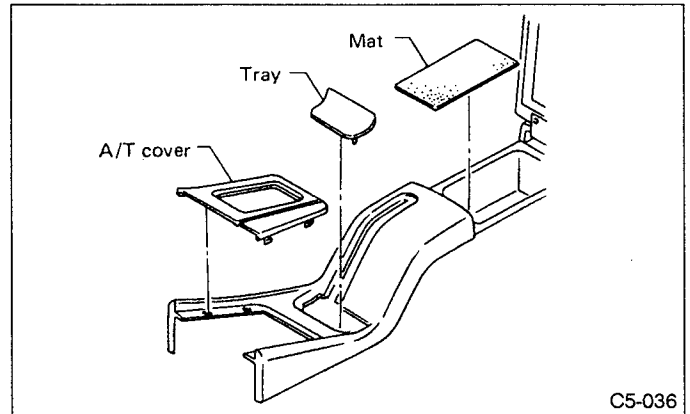

Fig. 6

- 5) Remove three screws from console box.

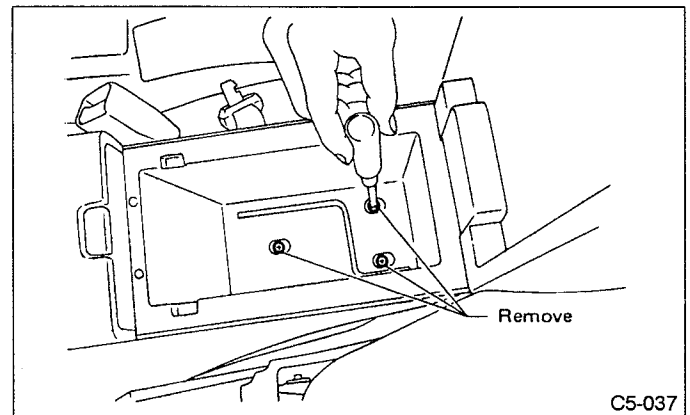

Fig. 7

- 6) Remove console box by lifting up while slightly pulling it backward.

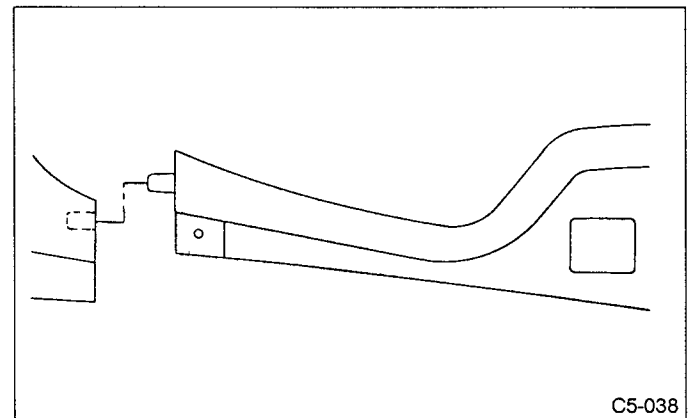

Fig. 8

B: INSTALLATION

- 1) Installation is in the reverse order of removal.

3. Instrument Panel

A: REMOVAL

CAUTION:

Be sure to hold socket section when disconnecting, not harness.

- 1) Disconnect ground cable from battery.
- 2) Remove console box.
- 3) Remove front pillar upper trim. (Refer to 5-3 [W11A0].)
- 4) Remove radio grounding wire.

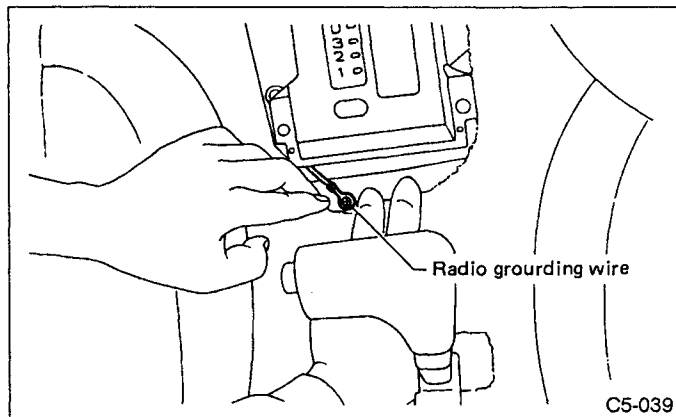

Fig. 9

- 5) Remove remote controlled rearview mirror switch and internal bolt.
Remove screw rivet located on lower side of lower cover.

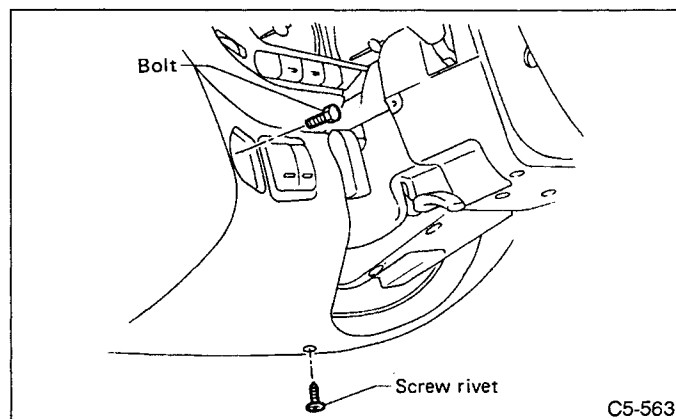

Fig. 10

- 6) Remove lower cover by removing six clips and three connectors.

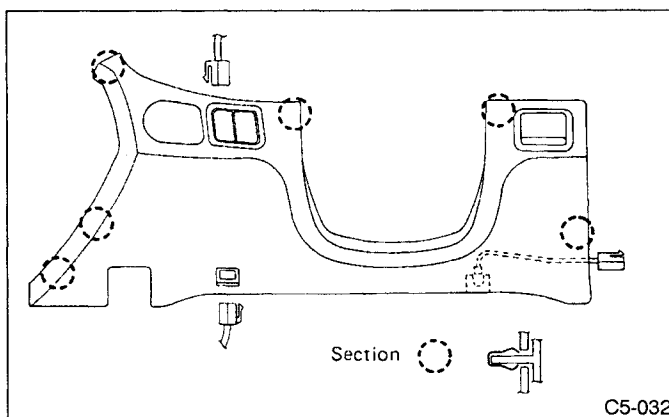

Fig. 11

- 7) Remove panel lower cover by removing four bolts.

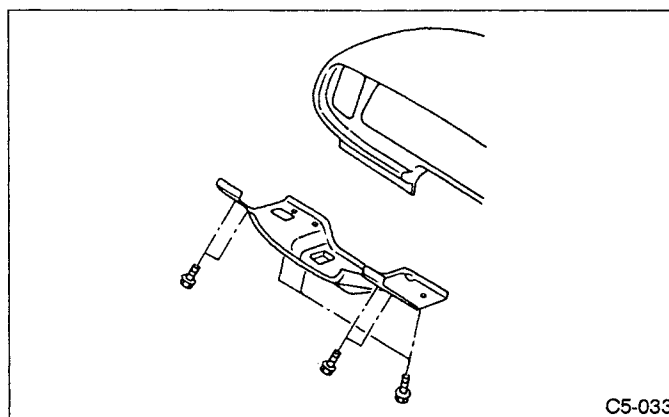

Fig. 12

- 8) Disconnect airbag connector at harness spool. (Refer to 5-5 [M1B6].)

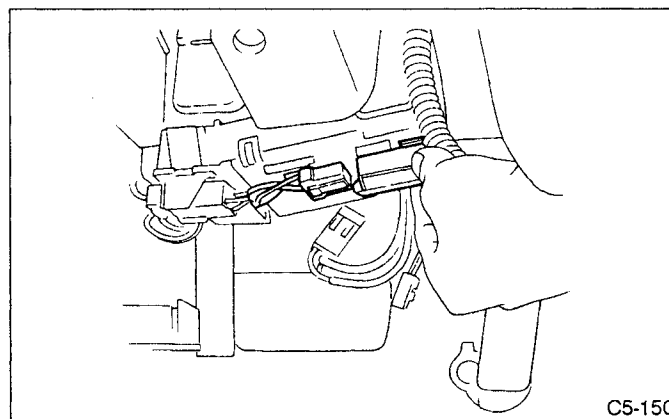

Fig. 13

9) Remove two screws from both the left and right sides.

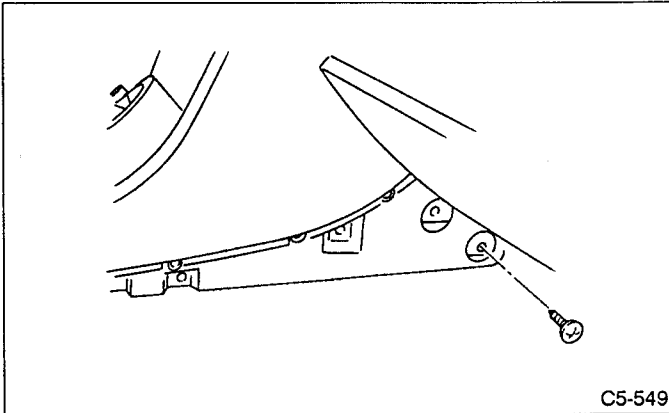

Fig. 14

11) Remove caps from both ends of instrument panel, and remove bolts.

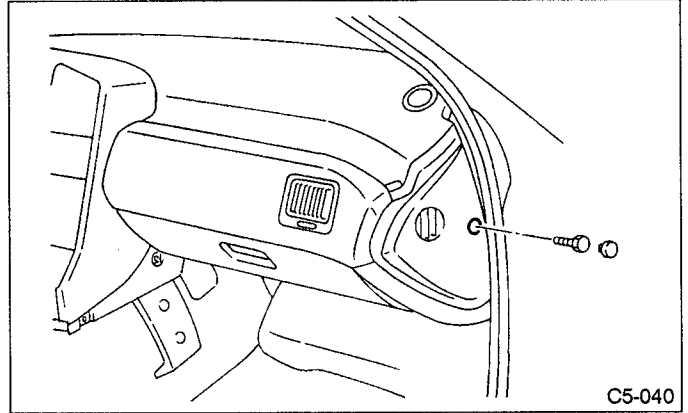

Fig. 16

10) Lower steering column.

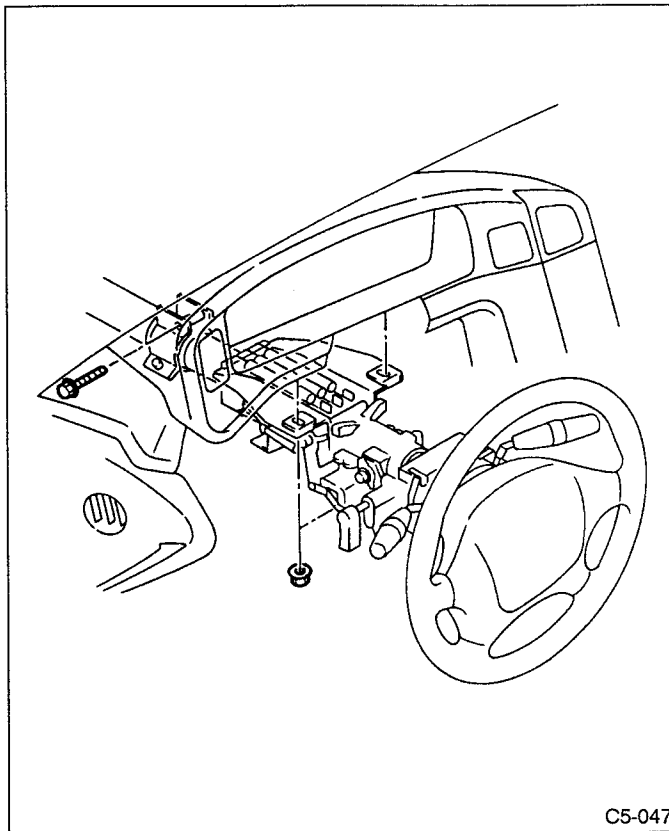

Fig. 15

12) Remove two instrument panel switches by pressing forward. Disconnect switch connectors.

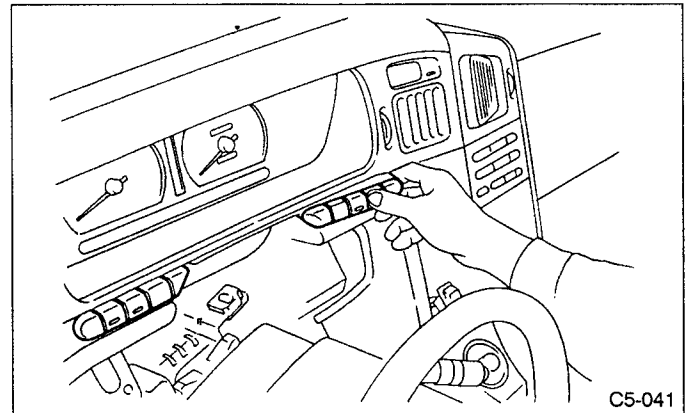

Fig. 17

13) Remove visor by removing seven screws, and disconnect clock connector.

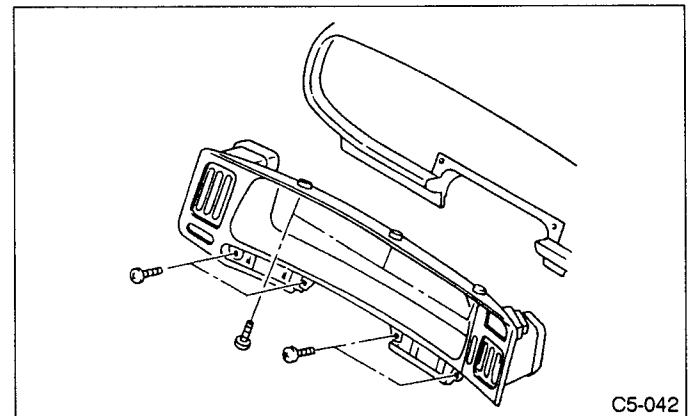

Fig. 18

14) Remove combination meter by removing six screws.

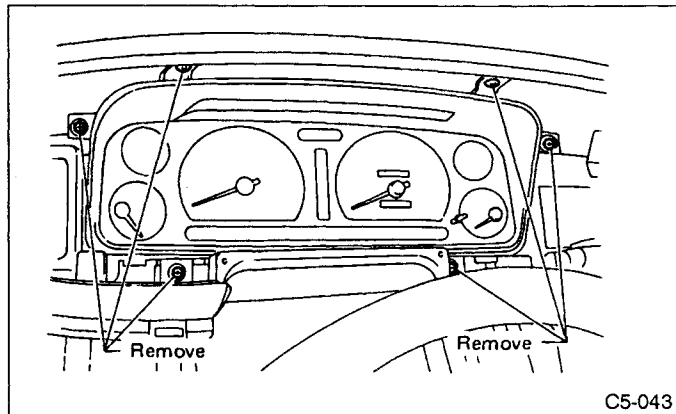

Fig. 19

15) Remove four bolts in meter visor.

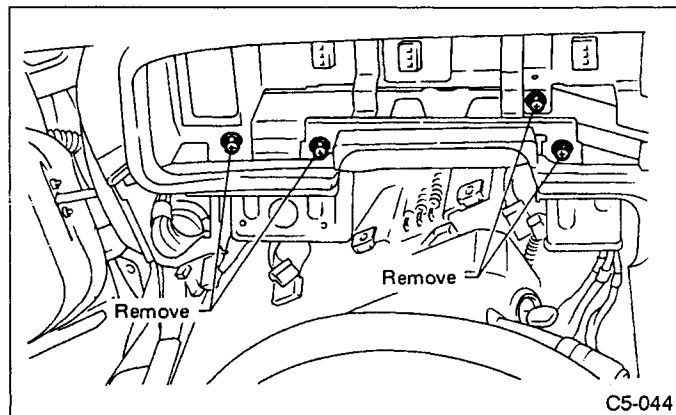

Fig. 20

16) Remove five screws in glove box.

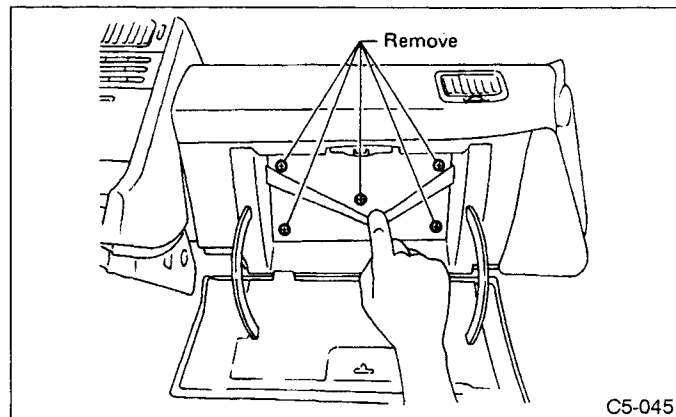

Fig. 21

17) Disconnect instrument harness and body harness at six connectors, and disconnect antenna lead at two places.

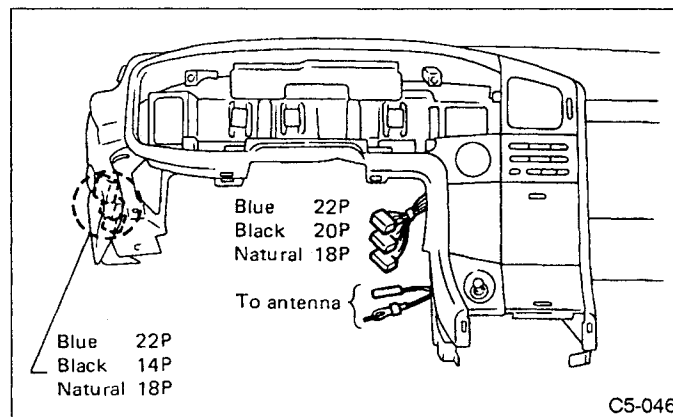

Fig. 22

18) Cover automatic transmission select lever and surrounding portion with cloth to avoid damaging.

19) Remove instrument panel by pulling it forward.

B: INSTALLATION

1) Installation is in the reverse order of removal.

Observe the following:

2) Push instrument panel into position by aligning five pins at the end of instrument panel with corresponding grommets on body side.

CAUTION:

Avoid jamming of any wire harness when installing instrument panel.

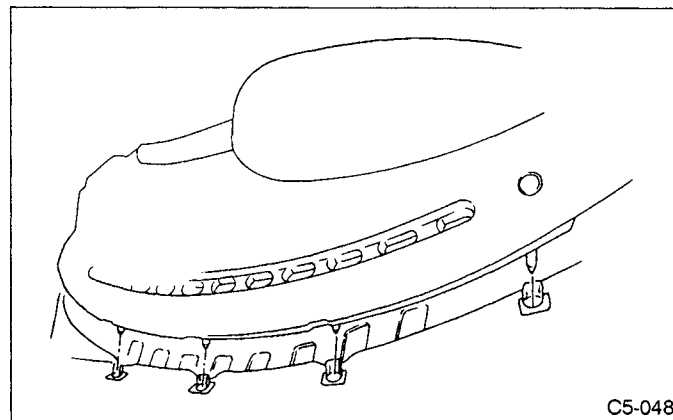

Fig. 23